



# FALLS CREEK SKI PATROL BASE

## FIRE ORDERS

FIRE EQUIPMENT LOCATION	
	FIRE EXTINGUISHER LOCATION
	FIRE BLANKET LOCATION
	FIRE EXIT

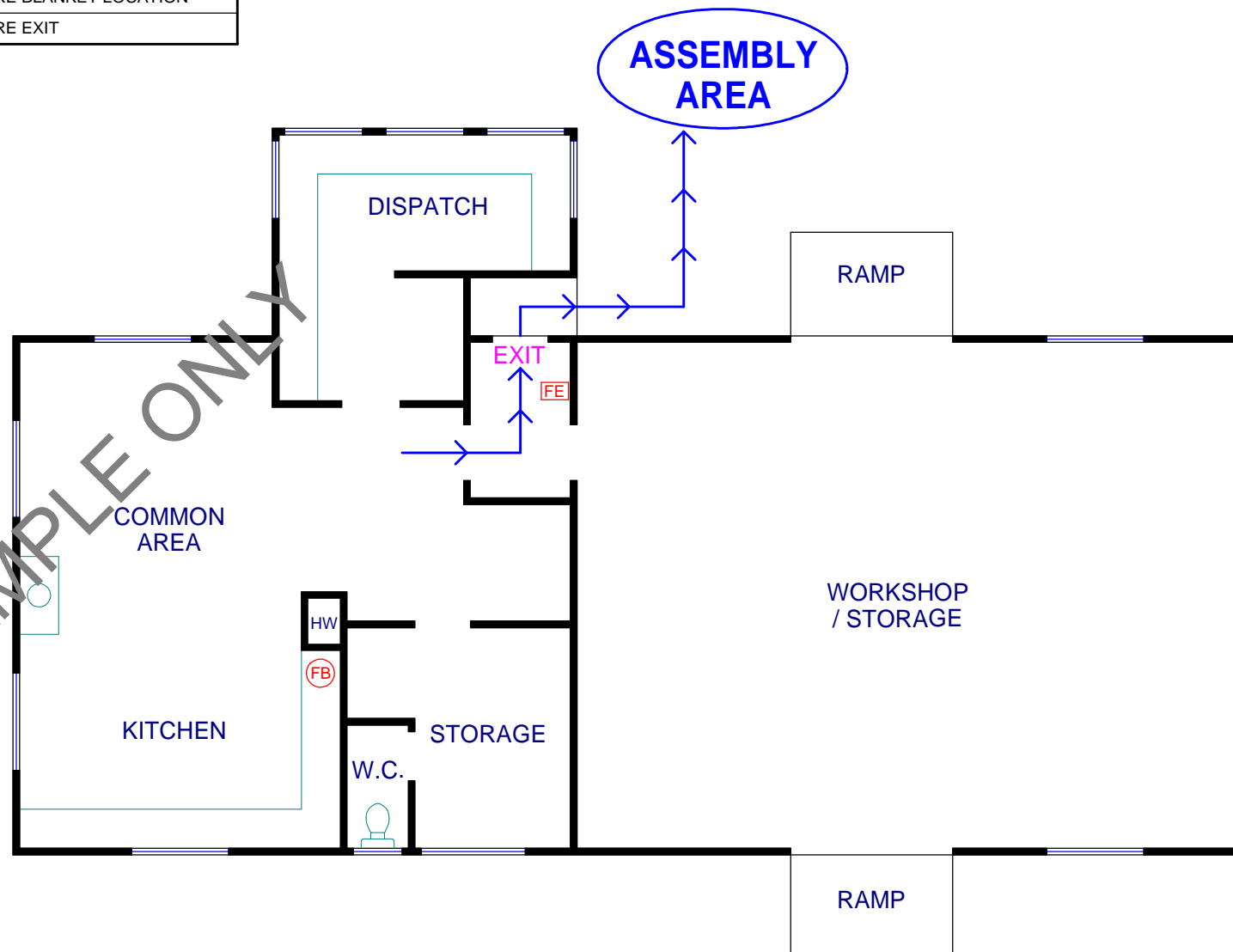

## EMERGENCY PROCEDURES

- Alert the appropriate authorities - Call the Fire Brigade on 000 and 5758 3642 and notify the Chief Warden
- Assist persons in immediate danger - Only if safe to do so
- Extinguish the fire - Only if safe to do so
- Close the door on the fire to contain the spread
- If threat of life exists evacuate immediately, closing all doors
- Check that all areas have been cleared and inform Chief Warden
- Control the evacuation to the Assembly Area
- The Assembly Area is \_\_\_\_\_
- Maintain control of everybody at the Assembly Area & ensure everybody is accounted for